

# Roger Clip-On Mic

1.1

User Guide



roger



**PHONAK**  
life is on

---

# Contents

<b>1. Welcome</b>	<b>4</b>
<b>2. Getting to know your Roger Clip-On Mic</b>	<b>6</b>
2.1 In the box	6
2.2 How the Roger Clip-On Mic works	7
2.3 Device descriptions	8
2.4 Indicator lights (LED status)	9
<b>3. Getting started</b>	<b>10</b>
3.1 Setting up the docking station	10
3.2 Charging your Roger Clip-On Mic	15
3.3 Switching on and off	18
3.4 Using Roger receiver	19
3.5 Connecting a receiver	20
<b>4. Using Roger Clip-On Mic</b>	<b>22</b>
4.1 Wearing Roger Clip-On Mic	22
4.2 Using the lanyard	24
4.3 Connecting to multimedia devices	27

---

<b>5. Special functions</b>	<b>29</b>
5.1 Mute	29
5.2 Disconnecting Roger devices (NewNet)	30
5.3 Verification mode	30
<b>6. Adding additional microphones</b>	<b>32</b>
6.1 Connect	32
6.2 Using additional microphones	36
<b>7. Troubleshooting</b>	<b>39</b>
<b>8. Important information</b>	<b>42</b>
<b>9. Service and warranty</b>	<b>48</b>
<b>10. Information and explanation of symbols</b>	<b>50</b>

---

# 1. Welcome

Congratulations on choosing the Roger Clip-On Mic from Phonak. This compact microphone uses adaptive wireless transmission to help people with a hearing loss understand more speech in noise and over distance. It is ideal for use by a partner or friend, plus it includes an audio input for listening to multimedia and TV connectivity. It can also be used alongside other Roger Clip-On Mics and Roger Pens in a microphone network.

Your Roger Clip-On Mic is a Swiss premium-quality product developed by Phonak, the world's leading hearing healthcare company.

---

Please read this User Guide thoroughly to benefit from all the possibilities your Roger Clip-On Mic offers.

If you have any questions, please consult your hearing care professional or local Phonak support center.

Phonak – life is on

[www.phonak.com](http://www.phonak.com)



---

## 2. Getting to know your Roger Clip-On Mic

### 2.1 In the box



Roger Clip-On Mic



Docking station



Power supply with country adapter and charging cable



Storage pouch



Lanyard



Star sticker



Audio cable for docking station



micro-USB audio cable (suitable for traveling)



RCA/Cinch adapter for TV or HiFi



Quick Setup Guide

---

## 2.2 How the Roger Clip-On Mic works

Roger Clip-On Mic transmits the speaker's voice directly into your ears. The system consists of three main elements: your hearing aids, Roger receivers and your Roger Clip-On Mic.

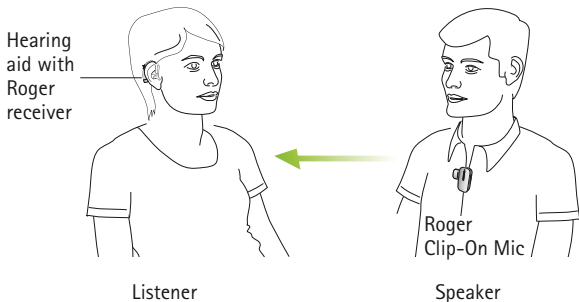

Your Roger Clip-On Mic and your hearing aid typically work within a range of up to 10 meters / 33 feet. Note that human bodies and walls may reduce this distance. The furthest range is possible when you can see your Roger Clip-On Mic (i.e. line of sight).

---

## 2. Getting to know your Roger Clip-On Mic

### 2.3 Device descriptions

#### Roger Clip-On Mic

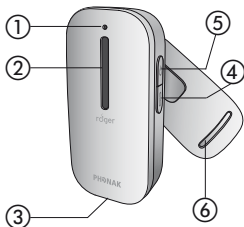

- ① Indicator light (LED)
- ② Microphones
- ③ Charging and audio input (micro-USB)
- ④ Connect
- ⑤ On/Off/Mute
- ⑥ Turnable clip

#### Docking station

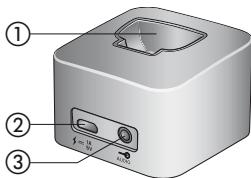









- ① Slot for Roger Clip-On Mic
- ② Charger input (micro-USB)
- ③ Audio input (3.5 mm / 1/8 inch jack)



---

## 2.4 Indicator lights (LED status)

<i>Indicator light</i>	<i>Meaning</i>
	Switched on
	Switching off
	Audio input detected
	Microphone / audio input muted
	Charging
	Fully charged
	Low battery – charge your Roger Clip-On Mic
	Your Roger microphone cannot detect the primary Roger microphone. Switch on the primary Roger microphone and make sure it is within range of your Roger microphone. Alternatively, if you don't want to use your Roger Clip-On Mic in a microphone network, press 7 seconds on the connect button until the LED turns orange. After that, you have to reconnect the Roger Clip-On Mic with your Roger receiver(s).

---

---

## 3. Getting started

### 3.1 Setting up the docking station

The Roger Clip-On Mic docking station is used to both recharge the microphone and transmit audio from a TV or other audio device to the Roger Clip-On Mic (and into your hearing aids).

#### Setting up the power supply

1. Select the power adapter that corresponds to your country.



US



EU



UK



AUS

2. Insert the round corner of the adapter in the round corner of the universal power supply.

3. Click the tail of the adapter in to lock it into place. Make sure the adapter is securely locked.

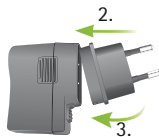

---

## Remove/Change:

- a. Pull back the tab on the universal power supply.
- b. Gently pull the adapter upwards to remove it.
- c. Start over with step 1 (above).

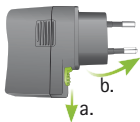

## Connecting the power supply to the docking station

1. Place the docking station next to your TV/audio device and connect the smaller end of the charging cable to the power input of the docking station ⚡  $\overline{\text{---}}$   $\frac{1\text{A}}{5\text{V}}$ .
2. Plug the larger end of the charging cable into the universal power supply.
3. Plug the power supply into an easily accessible power socket.

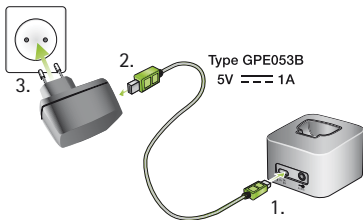

---

### 3. Getting started

#### Connecting the docking station to a TV/audio device

1. Plug the audio cable into the audio input of the docking station: 
2. Connect the other end of the audio cable to the headphone output of your TV/audio device.

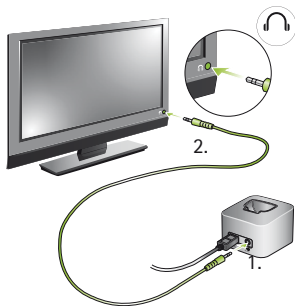

Alternatively, connect the other end of the audio cable to your TV's Cinch / RCA adapter. Connect the red and white plugs to the matching red and white output sockets on your TV.

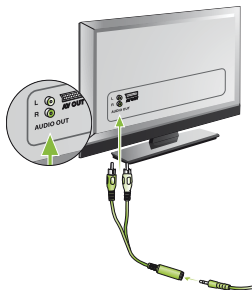

---

You can also connect via a SCART adaptor, which can be bought from an electronics store or from your Phonak dealer.

Connect the other end of the audio cable to the SCART adaptor.

Then plug the SCART adapter into a free SCART output socket on your TV.

If your TV does not include an analog audio output, you need a digital to analog converter. Such converters can be found in electronics stores or may be purchased from your Phonak dealer.



---

### 3. Getting started

- ① When the docking station is plugged into the headset socket of your TV, you can adjust the volume via your TV's remote control.
- ① Some TVs will switch off their loudspeakers when you plug the jack into the headset socket – meaning the TV will not be audible for other people. In such a case use the Cinch / RCA or SCART output socket as described above.
- ① The Roger Clip-On Mic docking station can also be connected to any other audio device such as an MP3 player, PC or HiFi system using the audio cable.

---

### 3.2 Charging your Roger Clip-On Mic

Roger Clip-On Mic contains a built-in lithium polymer battery with fast-charge capability.

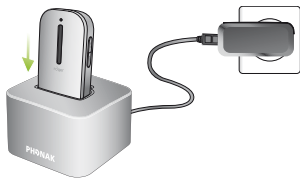

To charge your Roger Clip-On Mic, slot it into the docking station. The indicator light turns orange to indicate it is charging.

An empty battery will reach its maximum charge in approximately 2 hours. Charging is complete when the indicator light turns solid green.

- ① When charging your Roger Clip-On Mic for the first time, let it charge for at least two hours even if the battery indicator light is not lit or turns green earlier.

---

### 3. Getting started

Alternatively, you can also charge your Roger Clip-On Mic without the docking station. This may be useful when traveling.

Using the micro-USB cable:

1. Plug the smaller end (micro-USB) of the charging cable into your Roger Clip-On Mic.
2. Plug the larger end (USB) of the charging cable into the power supply.
3. Plug the power supply into an easily accessible power socket.

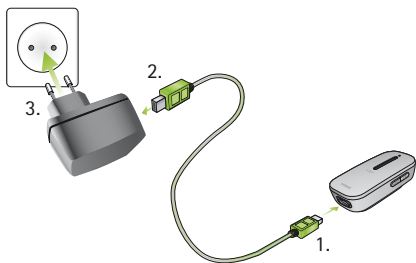



- 
- ① You can also charge your Roger Clip-On Mic by using the charging cable to connect your Roger Clip-On Mic to one of your computer's USB ports.
  - ① If you connect the charging cable to your computer's USB port and the docking station at the same time, your Roger Clip-On Mic will not charge.

## Indicator light (battery status)

*Indicator light*    *Meaning*



Charging



Fully charged



Low battery—charge your Roger Clip-On Mic. In addition, you will hear beeps in your hearing aids.

---

## 3. Getting started

### 3.3 Switching on and off

To switch your Roger Clip-On Mic on, press the on/off  button for one second until the indicator light turns green.



#### Indicator light (Switching on)

<i>Indicator light</i>	<i>Meaning</i>
	Powering on
	Switched on

---

### 3.4 Using Roger receiver

#### Using Roger MyLink

If your Roger receiver is a Roger MyLink, switch your Roger MyLink on and hang it around your neck.

Make sure your hearing aids are set to T/MT/T-Coil mode.

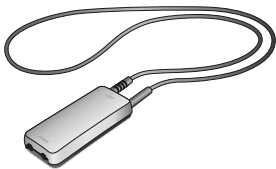

The Roger MyLink User Guide provides more detailed information on using Roger MyLink.

#### Using Roger receivers attached to your hearing aids

If you have Roger receivers that attach directly to your hearing aids, make sure these are properly attached and each hearing aid is set to its Roger/FM/DAI/EXT/AUX program.



---

### 3. Getting started

#### 3.5 Connecting a receiver

Your hearing care professional may already have connected your Roger Clip-On Mic with your hearing aids.

If this is not the case, connect your receiver to your Roger Clip-On Mic as follows:

1. Make sure Roger Clip-On Mic and the Roger receiver are both powered on.
2. Hold Roger Clip-On Mic within 10 cm / 4 inches of the Roger receiver.
3. Press the Connect  button on your Roger Clip-On Mic.

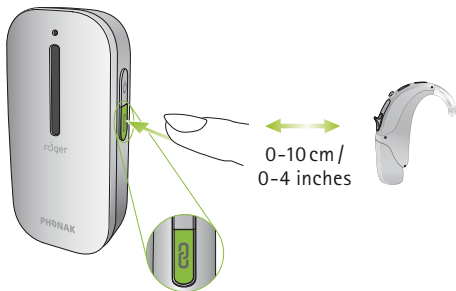



- 
- The indicator light will turn green for two seconds to confirm a successful connection.
  - Repeat steps 2 & 3 to connect a second receiver.
- i** Depending on the receiver type, you may connect a maximum of two Roger ear-level receivers OR one Roger MyLink to your Roger Clip-On Mic.

### Indicator light (connection status)

After pressing the Connect button, the following feedback may be given by the indicator light:

<i>Indicator light</i>	<i>Meaning</i>
------------------------	----------------

	Connection was successful – your Roger receiver is connected to your Roger Clip-On Mic.
	Roger Clip-On Mic could not find a Roger receiver. Move Roger Clip-On Mic closer to your Roger receiver and make sure the Roger receiver is powered. Then try to connect again.
	The Roger receiver is not compatible with your Roger Clip-On Mic.

---

## 4. Using Roger Clip-On Mic

### 4.1 Wearing Roger Clip-On Mic

The easiest way to attach Roger Clip-On Mic to the person speaking is by using its clip. There are different ways of clipping Roger Clip-On Mic to the speaker's clothes:



Clipped on the collar  
(clip downwards)

or



Clipped on clothing  
(clip upwards)

or



Clipped between buttons  
(clip sideways)

- 
- ① Make sure Roger Clip-On Mic points towards the speaker's mouth.
  - ① The distance between Roger Clip-On Mic and the speaker's mouth should not be greater than 20cm/8 inches.



max. 20 cm /  
8 inches



Too far away



Not pointing towards  
the mouth

---

## 4. Using Roger Clip-On Mic

### 4.2 Using the lanyard

If it's not possible to clip Roger Clip-On Mic to the speaker's clothing, you can alternatively use the lanyard to hang Roger Clip-On Mic around their neck.

#### Attaching the lanyard

1. Press the Roger Clip-On Mic clip and slide the plastic part of the lanyard over it.



2. Close the clip and make sure it is fully closed.

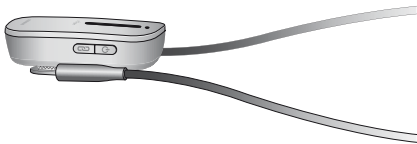



---

To remove the lanyard, open the clip and pull the lanyard out.

1.

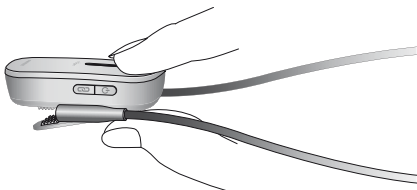

2.



---

## 4. Using Roger Clip-On Mic

### Hanging it around the neck

1. Open the lanyard by pulling the magnets apart.

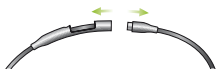

2. Hang the Roger Clip-On Mic around the neck of the speaker and close the lanyard.

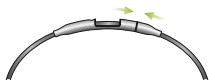

3. Adjust the length of the lanyard to bring Roger Clip-On Mic closer to the mouth. Secure the wire by pulling the cable into the gap.



4. The distance between Roger Clip-On Mic and the mouth should not be more than 20 cm / 8 inches.



---

## 4.3 Connecting to multimedia devices

You can connect your Roger Clip-On Mic to an audio source – such as your TV, tablet or HiFi – to hear its audio signal directly in your hearing aids.

### Via docking station

Make sure the docking station is powered properly connected to your audio source as described in 'Getting started' (page 12). Slot your Roger Clip-On Mic into the docking station. After turning on your audio source, Roger Clip-On Mic will automatically detect the presence of an audio signal and start transmitting it.



- ① If the docking station is not powered, Roger Clip-On Mic can still detect and transmit an external audio signal. Simply switch Roger Clip-On Mic on.
- ① When Roger Clip-On Mic transmits an audio signal its microphone is muted.

---

## 4. Using Roger Clip-On Mic

### Via micro-USB audio cable

Alternatively, you can use the short micro-USB audio cable to connect your multimedia device directly to your Roger Clip-On Mic.

1. Plug the round end of the micro-USB audio cable into the headphone output of your multimedia device.

2. Plug the rectangular end (micro-USB) of the micro-USB cable into the socket of your Roger Clip-On Mic.

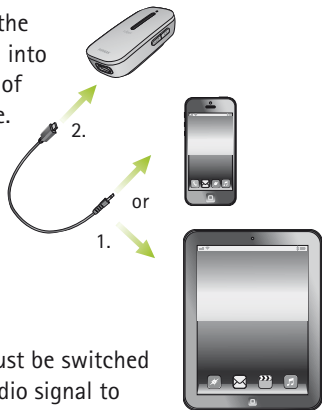

- i** Roger Clip-On Mic must be switched on to transmit the audio signal to your hearing aids. After you have activated your multimedia device's audio signal, Roger Clip-On Mic will detect this signal and will automatically mute its own microphone.

---

## 5. Special functions

### 5.1 Mute

Firmly press the on/off  button to mute Roger Clip-On Mic's microphone or audio input.

When muted, the indicator light will turn solid violet. Press the on/off button again to re-activate the microphones or audio input.



#### Indicator light (Mute)

<i>Indicator light</i>	<i>Meaning</i>
	Microphone / audio input muted

---

---

## 5. Special functions

### 5.2 Disconnecting Roger devices (NewNet)

To disconnect your Roger Clip-On Mic from any connected receivers or other Roger microphones, hold the Connect  button for 7 seconds. The indicator light will turn orange when Roger Clip-On Mic has been disconnected from all connected devices.

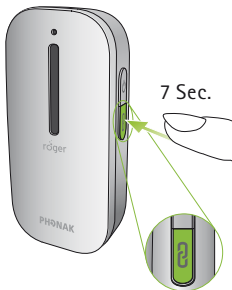

You can now re-start to connect Roger receivers or Roger microphones with your Roger Clip-On Mic.

### 5.3 Verification mode

The Verification mode is used by hearing care professionals to verify a device according the Roger POP (Roger Phonak Offset Protocol).

To activate verification mode, press the Connect  button 5 times in a row.

---

## Status light (Verification mode)

### *Indicator light*    *Meaning*

---





Verification mode activated

---

- ① Verification mode can only be activated during the 60 seconds after Roger Clip-On Mic is switched on.
- ① When Roger Clip-On Mic is switched off, Verification mode is automatically deactivated.

### Reset

If your Roger Clip-On Mic stops responding, reset the device by pressing the on/off  and Connect  buttons simultaneously for 7 seconds.

---

## 6. Adding additional microphones

Roger technology allows you to use multiple microphones in parallel by connecting additional Roger Clip-On Mics and Roger Pens.

### 6.1 Connect

To connect another microphone to your Roger Clip-On Mic, follow these steps:

1. Turn on both microphones.
2. Decide which Roger Clip-On Mic will be your primary device. Mark this device by placing the star sticker on the back.





- 
3. Hold the two microphones close together (within 10 cm / 4 inches).
  4. Press the Connect  button of the microphone with the star sticker.
- ① The primary microphone that controls the network is the Roger Clip-On Mic that you used to connect the additional microphones.

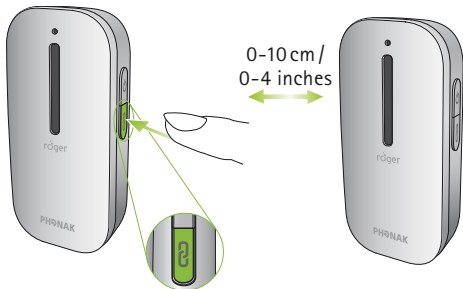

5. The indicator lights of both microphones will turn green for two seconds to confirm a successful connection.

---

## 6. Adding additional microphones

- ① Once you have connected another microphone to your primary microphone, it can only be used together with the primary. The other microphone will blink blue if it does not find your primary Roger Clip-On Mic. If you want to disconnect it from your primary Roger Clip-On Mic, use the NewNet function (see chapter 'Special Functions').
- ① If you want to connect your Roger Clip-On Mic with a Roger Pen, it is recommended to press the Connect button of the Roger Pen, making that the primary microphone.
- ① It is possible to connect up to 10 Roger microphones to your Roger Clip-On Mic.



---

## Indicator light (Connection status)

After pressing the Connect button, the following feedback may be given by the indicator light:

### *Indicator light*    *Meaning*

---

	Connection was successful – the other Roger microphone is now connected to your Roger Clip-On Mic.
	Roger Clip-On Mic could not find another Roger microphone. Move Roger Clip-On Mic closer to the other Roger microphone and make sure both microphones are switched on. Then try Connect again.
	The other Roger microphone is not compatible with your Roger Clip-On Mic.

---

---

## 6. Adding additional microphones

### 6.2 Using additional microphones

Hand over the Roger microphones to your speakers. Make sure they are worn properly (pointing to the mouth and within 20cm / 8 inches).

Roger Clip-On Mics automatically detect when your friend or partner talks, before instantly transmitting his / her voice to your hearing aids.

If a speaker wants to temporarily leave the group, they should mute their microphone by firmly pressing the on / off  button.

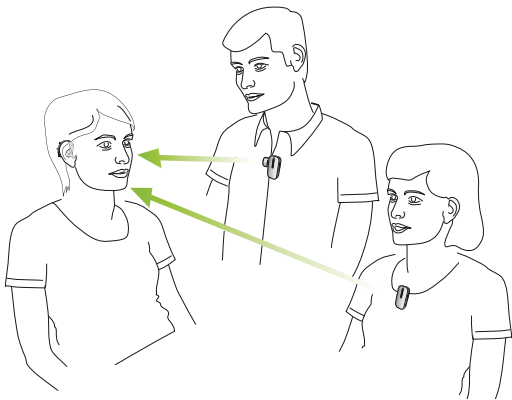

- 
- ① Only one speaker can be heard at a time. When two people speak at the same time, the person who talked first will be heard. When they stop talking, the other speaker will be heard.
  - ① The speaker with the primary microphone (the one with the ★ sticker on the back) should stay within 10m/30 feet of the group. If the speaker with the primary Roger Clip-On Mic wants to temporarily leave the group, he should leave the microphone within the group.
  - ① If the primary Roger Clip-On Mic is turned off or moves out of range, the secondary Roger microphones will start blinking blue and will stop transmitting.

---

## 6. Adding additional microphones

### Indicator light (multiple microphone status)

When using multiple Roger microphones, the following feedback may be given by the indicator light:

<i>Indicator light</i>	<i>Meaning</i>
	Your Roger microphone is muted. Unmute it by pressing the on/off  button.
	Your Roger microphone cannot detect the primary Roger microphone. Switch on the primary Roger microphone and make sure it is within range of your Roger microphone. Alternatively, if you don't want to use your Roger Clip-On Mic in a microphone network, press 7 seconds on the connect button until the LED turns orange. After that, you have to reconnect the Roger Clip-On Mic with your Roger receiver(s).

## 7. Troubleshooting

*Most probable cause(s)*

*Solution(s)*

### I cannot switch Roger Clip-On Mic on

■ The battery is empty

■ Charge Roger Clip-On Mic for at least two hours

### I cannot understand the speaker

■ The microphone is not positioned correctly

■ Move Roger Clip-On Mic closer to the speaker's mouth

■ Make sure Roger Clip-On Mic is pointing towards the speaker's mouth

■ The microphone openings are covered by fingers or clothing

■ Make sure the microphone openings are not covered by fingers, clothing or dirt

### I cannot hear the speaker's voice even though Roger Clip-On Mic is switched on

■ The microphone has been muted

■ Check the indicator light – if it is violet, briefly press the on/off button to activate the microphones

■ Your hearing aids are not set to the correct program

■ Check that your hearing aids are set to the correct program (Roger / FM / DAI / EXT / AUX)

■ Your Roger receivers are not connected to Roger Clip-On Mic

■ Hold Roger Clip-On Mic close to each Roger receiver in turn and briefly press the Connect button

## 7. Troubleshooting

### *Most probable cause(s)*

- In case of multiple microphones, the primary microphone may not be switched on or may be out of range

### *Solution(s)*

- Check the indicator light – if it is blinking red, switch on the primary microphone and check that it is within range

### I keep losing the audio signal

- Distance between Roger Clip-On Mic and Roger receiver is too large
- There are obstacles between you and Roger Clip-On Mic

- Move closer to the Roger Clip-On Mic
- Make sure you can see the Roger Clip-On Mic (line of sight)

### The volume from my multimedia device is too low

- Incorrect volume settings

- Increase the volume of your audio source

### I cannot hear my multimedia device

- The audio source is muted
- Roger Clip-On Mic is using micro-USB audio cable but is not switched on

- Unmute the audio source
- Switch on Roger Clip-On Mic to listen to the audio source via the micro-USB audio cable



---

*Most probable cause(s)*

*Solution(s)*

**Roger Clip-On Mic's light is blinking blue**

■ Your Roger Clip-On Mic has been connected to another microphone which is no longer available

■ Create a NewNet (press the Connect button for 7 seconds) to make Roger Clip-On Mic a standalone transmitter again

**The Roger Clip-On Mic's light is blinking red (double flash)**

■ Its battery charge is low

■ Charge Roger Clip-On Mic as soon as possible

**Roger Clip-On Mic has stopped working**



■ Software issue

■ Reboot Roger Clip-On Mic by simultaneously pressing it's two buttons

---

## 8. Important information

### 8.1 Important Safety Information

-  Please read the information on the following pages before using your Phonak device.
-  This symbol on the product or its packaging means  that it should not be disposed of with your other household waste. It is your responsibility to dispose of your waste equipment separately from the municipal waste stream. The correct disposal of your old appliance will help prevent potential negative consequences for the environment and human health.

---

## 8.2 Hazard warnings

- ⚠ Keep this device out of reach of children aged under 3 years.
- ⚠ Opening the device might damage it. If problems occur that cannot be resolved by following the guidelines in the Troubleshooting section of this User Guide, consult your hearing care professional.
- ⚠ Your device should only be repaired by an authorized service center. Changes or modifications to this device that were not explicitly approved by Phonak are not permitted.
- ⚠ Please dispose of electrical components in accordance with your local regulations.
- ⚠ Do not use your device in areas where electronic equipment is prohibited. If in doubt, please ask the person in charge.
- ⚠ Device should not be used on aircrafts unless specifically permitted by flight personnel.

---

## 8. Important information

- ⚠ External devices should only be connected if they have been tested in accordance with corresponding IECXXXXX standards.
- ⚠ Only use accessories that are approved by Phonak AG.
- ⚠ Using your device's cables in any way contradictory to their intended purpose (e.g., wearing the USB cable around the neck) can cause injury.
- ⚠ When operating machinery, ensure that no parts of your device can get caught in the machine.
- ⚠ Do not charge device while it is on your body.
- ⚠ Caution: electric shock. Do not insert plug alone into electrical outlets.

---

## 8.3 Product safety information

- ① Protect the device from excessive shock and vibration.
- ① Do not expose your device to temperatures and humidity outside of the recommended conditions stated in this User Guide.
- ① Never use a microwave or other heating devices to dry the device.
- ① Clean the device using a damp cloth. Never use household cleaning products (washing powder, soap, etc.) or alcohol to clean the device.
- ① Only recharge your device using chargers supplied by Phonak or by stabilized chargers providing 5VDC and  $\geq 500$  mA.
- ① Do not connect an USB or audio cable to your device that exceeds 3 meters (9 ft) in length.
- ① When the device is not in use, turn it OFF and store it safely.

---

## 8. Important information

- ① Protect the device from excessive moisture (bathing, swimming), heat (radiator, car dashboard), and direct contact with skin when sweating (workout, fitness, sport).
- ① X-ray radiation, CT or MRI scans may destroy or adversely affect the correct functioning of the device.
- ① Do not use excessive force when connecting your device to its different cables.
- ① Protect all openings (microphones, audio input and charger) from dirt and debris.
- ① If the device has been dropped or damaged, if it overheats during charging, has a damaged cord or plug, or has been dropped into liquid, stop using your device and contact your hearing care professional.
- ① The device has a built-in rechargeable battery. This battery can be charged and discharged hundreds of times but may eventually wear out. The battery may then only be replaced by authorized personnel.

---

## 8.4 Other important information

- Persons with pacemakers or other medical devices should ALWAYS consult their physician or the manufacturer of their device BEFORE using the device. The use of the device with a pacemaker or other medical devices should ALWAYS be in accordance with the safety recommendations of the physician responsible for your pacemaker or the pacemaker manufacturer.
- Device collects and stores internal technical data. This data may be read by a hearing care professional in order to check the device, as well as to help you use your device correctly.
- The digital signal sent from the device to a connected receiver cannot be overheard by other devices which are not in the microphone's network.

---

## 9. Service and warranty

### 9.1 Local warranty

Please ask the hearing care professional, where you purchased your device, about the terms of the local warranty.

### 9.2 International warranty

Phonak offers a one year limited international warranty, valid as of the date of purchase. This limited warranty covers manufacturing and material defects. The warranty is valid only if proof of purchase is shown.



---

### 9.3 Warranty limitation

This warranty does not cover damage from improper handling or care, exposure to chemicals, immersion in water or undue stress. Damage caused by third parties or non-authorized service centers renders the warranty null and void. This warranty does not cover any services performed by a hearing care professional in his/her office.

Serial number:

\_\_\_\_\_

Authorized hearing  
care professional  
(stamp/signature):

Date of purchase:

\_\_\_\_\_

\_\_\_\_\_

---

## 10. Information and explanation of symbols



The CE symbol is confirmation by Phonak Communications AG that this Phonak product is in compliance with the essential requirements and other relevant provisions of Directive 1999/5/EC.

---



This symbol indicates that it is important for the user to read and take into account the relevant information in these user guides.

---



This symbol indicates that it is important for the user to pay attention to the relevant warning notices in these user guides.

---



Important information for handling and product safety.

---

## Operating conditions

This device is designed such that it functions without problems or restrictions if used as intended, unless otherwise noted in these user guides.



Australian EMC and Radiocommunications compliance label.



Temperature:  $-20^{\circ}$  to  $+60^{\circ}$  Celsius  
( $-4^{\circ}$  to  $+140^{\circ}$  Fahrenheit).



Humidity transportation: Up to 90%  
(non condensing).  
Humidity storage: 0% to 70%, if not  
in use.



Atmospheric pressure: 500 hPA to  
1100 hPA

---

## 10. Information and explanation of symbols



The symbol with the crossed-out garbage bin is to make you aware that this device may not be thrown away as normal household waste. Please dispose of old or unused device, at waste disposal sites intended for electronic waste, or give your device to your hearing care professional for disposal. Proper disposal protects the environment and health.

This product has an embedded, non-replaceable battery. Do not attempt to open the product or remove the battery as this may cause injury and damage the product.

Please contact the local recycling facility for removal of the battery.







**Manufacturer:**

Phonak Communications AG

Laenggasse 17

CH-3280 Murten

Switzerland

[www.phonak.com/phonak-roger](http://www.phonak.com/phonak-roger)

